

P Series wire rope pullers

1,000 and 2,000 lb capacities

Wire puller features

- 4:1 design factor meets ASME B30.21
- Handle and frame are made of heavy-gauge steel with rivet construction and slip-resistant grip; all steel parts are plated for long life
- Solid “buttress tooth” cast gear design has no laminated plates
- Sturdy steel drive and holding pawls have long life, stainless-steel springs; all pivot points are hardened steel
- Safety latch hooks are drop-forged steel, heat-treated, and plated for corrosion resistance; top hook rotates 360° for easy operation
- Cast-aluminum drum has through-the-drum anchor, larger diameter, and drum guard so the wire rope will stay tight, bend less, and spool evenly while rewinding
- Galvanized aircraft-quality wire rope is preformed to prevent kinks
- One-year warranty

P Series Specifications

Model	Capacity lb	Number of Lines	Pull to Lift Rated Load		Cable Diameter	Min. “A” dist. Between Hooks	Lifting Distance	Number of Hooks	Shipping Weight with 10' of Lift	
			lb	kg	in	in	ft		lb	kg
P15H	1,000	1	100	45.5	3/16	19.5	15	2	8.5	3.9
P15D3H	1,000	1	100	45.5	3/16	21	15	3	10.5	4.8
P15D3H	2,000	2	105	47.7	3/16	27.5	7.5	3	10.5	4.8

Dimensions are subject to change.

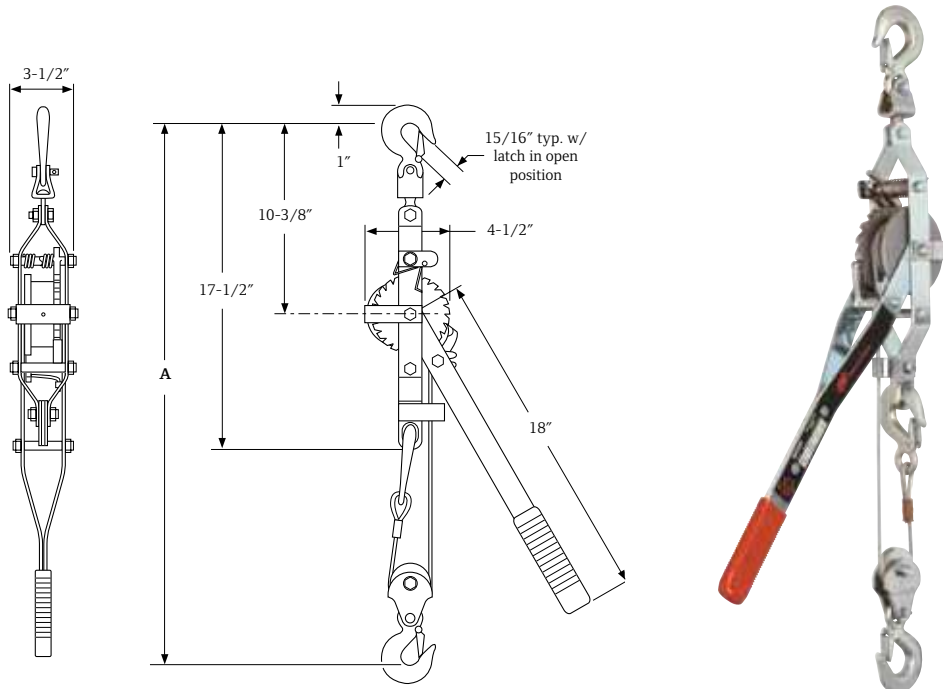

C Series wire rope and strap pullers

1,700 to 4,000 lb capacities

Cable puller features

- 4:1 design factor for lifting, lowering, and pulling applications; meets ASME B30.21
- Lightweight aluminum frame
- Alloy steel load hook with safety latches
- One-piece cast aluminum drum
- Galvanized, aircraft-quality wire rope
- Ratchet and pawl system provides safe, one-notch-at-a-time lowering
- Cable guide and shield protects wire rope and spools cable evenly
- Reversible handle changes position easily, so pull is always possible against the load

Strap puller features

Part of the premium C Series, these strap pullers offer the following unique features:

- Increased capacity with smooth, non-marring web strap
- Non-conductive, corrosion-resistant, high-strength synthetic strap will not kink or bind
- Easy payout of strap for fast setup



C Series Specifications

Model	Capacity lb	Number of Lines	Pull to Lift Rated Load		Cable Diameter	Min. "A" dist. between hooks	Lifting Distance	Number of Hooks	Shipping Weight with 10' of Lift	
			lb	kg	in	in	ft		lb	kg
C400H	1,700	1	57	25.9	1/4	17	20	2	16	7.3
C400H	3,400	2	62	28.2	1/4	22	10	3	16	7.3
C400S	2,000	1	65	29.5	3/32 x 1-7/8	17	12	2	16	7.3
C400S	4,000	2	70	31.8	3/32 x 1-7/8	22	6	3	16	7.3

Dimensions are subject to change.

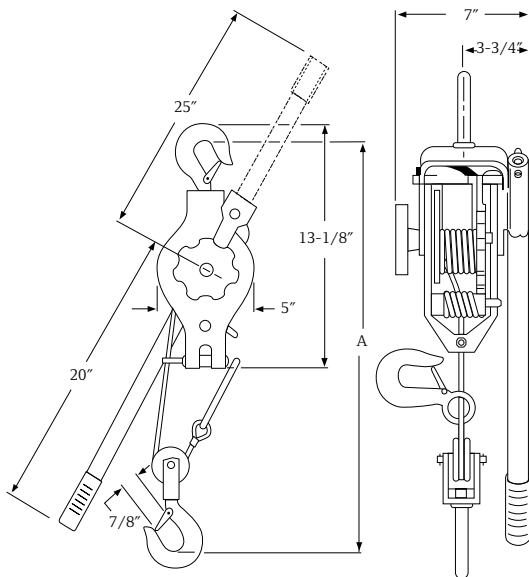

Overload safety handle is designed to bend when an overload is detected. Once the handle begins to bend, additional force will limit the hoist from lifting beyond its capacity.

